



**Termignoni S.p.A.**  
**Via della Rampina, 1**  
**I-15077 Predosa (AL)**  
**Italy**

**APPLICATION FOR APPROVAL OF SEPARATE TECHNICAL  
UNIT OF EXHAUST SYSTEMS FOR MOTORCYCLE  
PURSUANT  
TO REGULATION (EU) 134/2014**

**UNIFORM PROVISIONS CONCERNING THE APPROVAL OF  
TWO- OR THREE-WHEEL VEHICLES AND QUADRICYCLES  
WITH REGARD TO NOISE-ABATEMENT DEVICE**

**Total number of pages: 11**

**Predosa, IT**  
**07.06.2017**

  
**Technical manager**





**INFORMATION DOCUMENT**  
**N° H142/134/2014 rev. 00**

**Date: 07/06/2017**  
**Page 2/6**

## **Confirmation**

**We declare hereby that the specimen submitted for this approval test have been manufactured and assembled in conditions of ordinary mass production and that they are compatible with the enclosed documentation.**

**Predosa, IT**  
**07.06.2017**

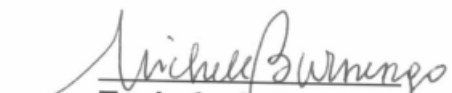
  
**Technical manager**





## Contents

Confirmation .....	2
0. GENERAL INFORMATION.....	4
1. GENERAL CONSTRUCTION CHARACTERISTICS.....	5
Appendix 1 - Composition of the original exhaust system + original parts .....	1
<b>Enclosures:</b>	
Appendix 2 - Drawing of silencer "H142: SILENCER"	pages 1
Appendix 3 - Drawing of composition "H142: ASSEMBLY"	pages 1
Appendix 4 - Drawing of DB Killer "H142: Tappo"	pages 1
Appendix 5 - Fitting instructions	pages 1





**0. GENERAL INFORMATION**

**B. General information concerning systems, components or separate technical units**

**0.7. Make (trade name of manufacturer):** Termignoni

**0.8. Type:** H142

    Variants: SSSF, SSTF, STSF, STTF, TSSF, TSTF, TTSTF, TTTF, CSSF, CSTF, CTSF, CTTF

for details see page 6.

0.8.1. Commercial name (if available): N/A

0.8.2. Type-approval number (if available): N/A

0.8.3. Type-approval issued on (date, if available): N/A

**0.9. Company name and address of manufacturer:** Termignoni S.p.A.  
Via della Rampina, 1  
I-15077 Predosa (AL)  
Italy

0.9.1. Name and address of assembly plants: Termignoni S.p.A.  
Via della Rampina, 1  
I-15077 Predosa (AL)  
Italy

0.9.2. Name and address of manufacturer's authorised representative, if any:  
N/A

**0.10. Vehicle for which the system/separate technical unit is intended for**

0.10.1. Type: RC95  
Honda Motor Co., Ltd  
e11\*168/2013\*00212\*01  
1

0.10.2. Variant:

0.10.3. Version: 1/1

0.10.4. Commercial name (if available): ADV750

0.10.5. Category, subcategory and sub-subcategory of vehicle: L3e-A3

**C. General information concerning vehicle, systems, components or separate technical units**

**0.12. Conformity of production**

0.12.1. Description of overall quality-assurance management systems  
according to described internal quality management  
initially assessment has been executed





## **1. GENERAL CONSTRUCTION CHARACTERISTICS**

### **1.8. Propulsion unit performance**

- |        |  |   |
|--------|--|---|
| 1.8.1. | Declared maximum vehicle speed:                                      | 171 km/h  |
| 1.8.3. | Maximum net power combustion engine:                                 | 40,3 kW at 6250 min <sup>-1</sup><br>at A/F ratio: 12,3 |
| 1.8.4. | Maximum net torque combustion engine:                                | 68 Nm at 4750 min <sup>-1</sup><br>at A/F ratio: 12,4   |
| 1.8.5. | Maximum continuous-rated power electric motor (15/30 minutes power): | N/A   |
| 1.8.6. | Maximum continuous-rated torque electric motor:                      | N/A   |
| 1.8.7. | Maximum continuous total power for propulsion:                       | N/A   |
| 1.8.8. | Maximum continuous total torque for propulsion:                      | N/A   |
| 1.8.9. | Maximum peak power for propulsion:                                   | N/A   |

## **4. GENERAL INFORMATION ON ENVIRONMENTAL AND PROPULSION UNIT PERFORMANCE**

- |        |   |             |
|--------|---|-------------|
| 4.0.   | General information on environmental and propulsion performance |             |
| 4.0.1. | Environmental step:   | 4           |
| 4.0.2. | Fuel consumption:   | 85 g/km     |
| 4.0.3. | CO <sub>2</sub> emissions:                                      | 3,7 l/100km |
| 4.0.4. | Energy consumption:   | N/A         |
| 4.0.5. | Electric range:   | N/A         |
| 4.0.6. | Limit value for L <sub>urban</sub> :                            | 77 dB(A)    |

### **4.4. Additional information on environmental and propulsion unit performance**

- |        |  |     |
|--------|--|-----|
| 4.4.4. | Applicable information document set out in respectively UN Regulation No 92 shall supplement this information document with regards to the noise-abatement devices installed on the vehicle. | N/A |
|--------|--|-----|

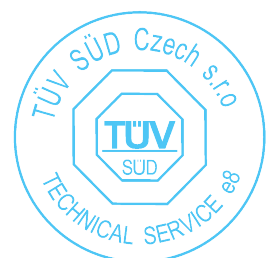



**Technical description:**

Non-original exhaust system, consisting of one silencer of cylindrical shapes, with polygonal section, on the rear of the vehicle on right side. The maximum section's sizes are 118x138 mm and the total length is 554 mm (with endcap and junction pipe), absorption-reflection principle with outlet pipe of 42x28 mm (inner section), according to drawings no. H142: TAPPO in combination with original header system. The silencer has been made in Stainless steel or as alternative in Titanium or in Carbon fiber.

Repair and maintenance information are in manual and webpage: [www.termignoni.it](http://www.termignoni.it)

**Position and direction of the tail pipe:**

On the right side of the vehicle

**Used materials:**

- SSSF: Stainless Steel (Shell), Stainless Steel (outlet pipe), Stainless Steel (punched-holes Pipe), Fiber Glass (sound deadener).
- SSTF: Stainless Steel (Shell), Stainless Steel (outlet pipe), Titanium(punched-holes pipe), Fiber Glass (sound deadener).
- STSF: Stainless Steel (Shell), Titanium(outlet pipe),Stainless Steel (punched-holes pipe), Fiber Glass (sound deadener).
- STTF: Stainless Steel (Shell), Titanium(outlet pipe), Titanium(punched-holes pipe), Fiber Glass (sound deadener).
- TSSF: Titanium(shell), Stainless Steel (outlet pipe), Stainless Steel (punched-holes pipe), Fiber Glass (Sound Deadener).
- TSTF: Titanium(shell), Stainless Steel (outlet pipe), Titanium(punched-holes pipe), Fiber Glass (sound deadener).
- TTSTF: Titanium(shell), Titanium(outlet pipe),Stainless Steel (punched-holes pipe), Fiber Glass (sound deadener).
- TTTF: Titanium(shell), Titanium(outlet pipe),Titanium(punched-holes pipe), Fiber Glass (sound deadener).
- CSSF: Carbon Fiber (shell), Stainless Steel (outlet pipe), Stainless Steel (punched-holes pipe), Fiber Glass (sound deadener).
- CSTF: Carbon Fiber (shell), Stainless Steel (outlet pipe), Stainless Steel (punched-holes pipe), Fiber Glass (sound deadener).
- CTSF: Carbon Fiber (shell), Titanium(outlet pipe), Stainless Steel (punched-holes pipe), Fiber Glass (sound deadener).
- CTTF: Carbon Fiber (shell), Titanium(outlet pipe), Titanium(punched-holes pipe), Fiber Glass (sound deadener).

**Place of marking:**

On the silencers, see enclosed drawings of silencers and composition  
"H142: SILENCER"



## INFORMATION DOCUMENT N° T010/134/2014 rev. 00 – Appendix 1

### Appendix 1 - Composition of the original exhaust system + original parts

No.	Components parts, dimensions in mm	Dimensions of the part in mm or original part / replacement part	Part no. or homologation no.
1)	Collectors and final body	Original part	--
2)	Catalytic converter	Original part	--
3)	Silencers (outlet pipe section 42x28 mm)	One silencer of cylindrical shapes, with polygonal section, on the rear of the vehicle on right side. The maximum section's sizes are 118x138 mm and the total length is 554 mm (with endcap and junction pipe), absorption-reflection principle with outlet pipe of 42x28 mm (inner section), according to drawings no. H142: TAPPO in combination with original header system. The silencer has been made in Stainless steel or as alternative in Titanium or in Carbon fiber.	H142: SILENCER

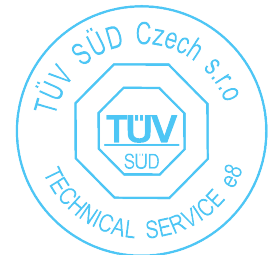

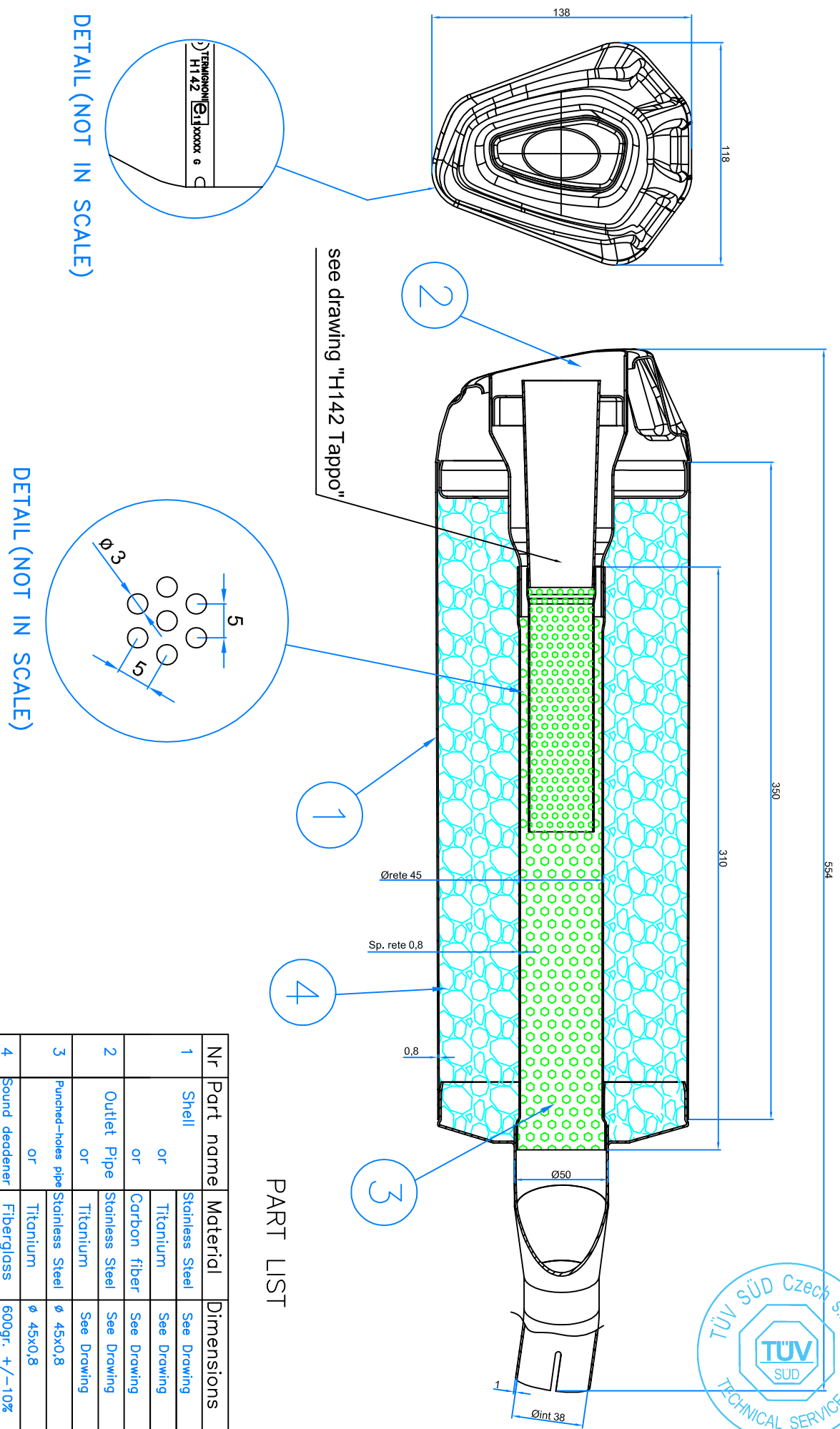

PART LIST

Nr	Part name	Material	Dimensions	QT
1	Shell	Stainless Steel	See Drawing	1x
	or	Titanium	See Drawing	1x
	or	Carbon fiber	See Drawing	1x
2	Outlet Pipe	Stainless Steel	See Drawing	1x
	or	Titanium	See Drawing	1x
3	Punched-holes pipe	Stainless Steel	See Drawing	1x
	or	Titanium	See Drawing	1x
4	Sound deaener	Fiberglass	600gr. +/-10%	1x

SCALE:

DATE: 04/05/2017

NAME: C. Zappia

TYPE: H142 SILENCER

MODEL:

Honda X-ADV

1 Sil. cod. H142

H142 e11 XXXXX G

Termignoni

s.p.a.

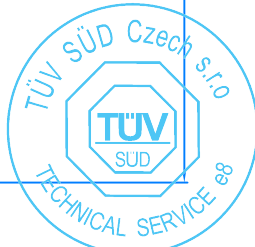



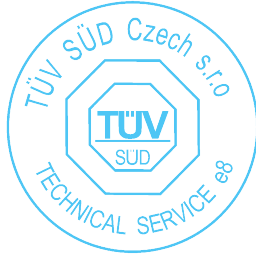

SILENCER  
see drawing "H142 Silencer"

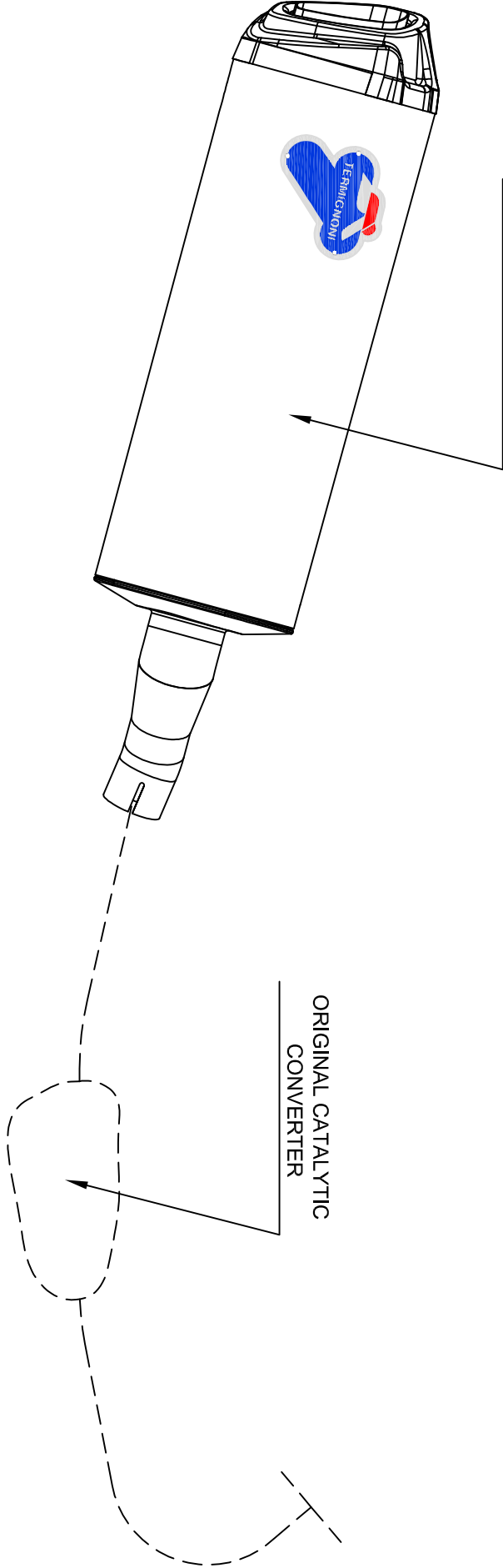

<b>SCALE:</b>		<b>MODEL:</b>	
<b>DATE:</b> 04/05/2017		Honda X-ADV	
<b>NAME:</b> C.ZAPPIA		1 Sil. cod. H142	
<b>TYPE:</b> H42 ASSEMBLY		H142 e11 XXXXX G	

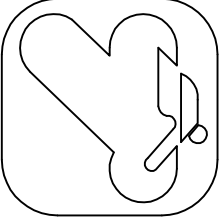

**Termignoni** s.p.a.

[www.termignoni.it](http://www.termignoni.it)

General tolerance:  $\pm 1\text{ mm}$

MATERIAL: S.Steel or Titanium

INFORMATION DOCUMENT N° H142/134/2014 rev. 00  
Appendix 4 - Drawing of DB Killer "H142: Tappo"

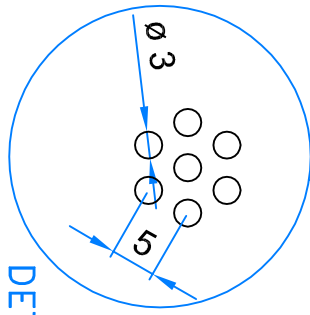
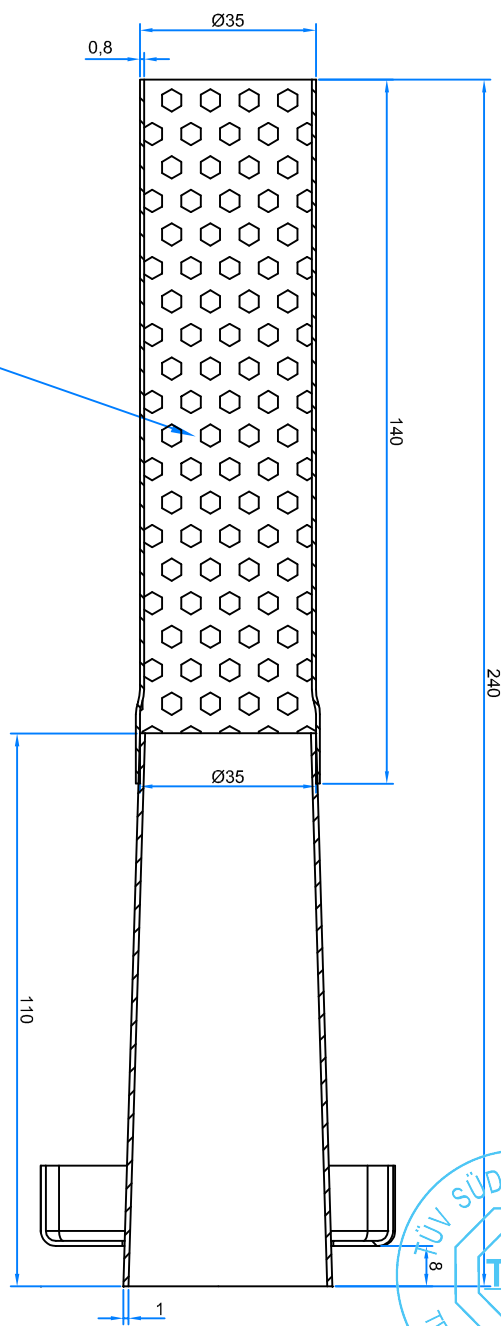
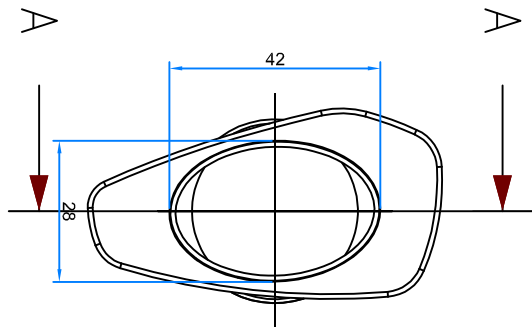

DETAIL (NOT IN SCALE)

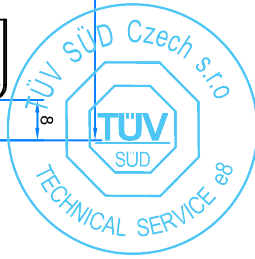

Cod. TERMIGNONI TER647

SCALA:	MODEL:
DATUM: 04/05/2017	Honda X-ADV
NAME: E. VRAPL	1 Sil. cod. H142
	H142 e11 XXXXX G
Type:	H142 Tappo

Termignoni s.p.a.

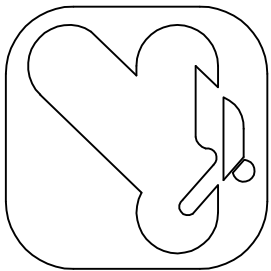

info@termignoni.it



Termignoni s.p.a.  
Via della Rampina, 1  
15077 PREDOSA (AL) Italy  
Telef. +39 0131.71666  
Fax +39 0131.71696  
[www.termignoni.it](http://www.termignoni.it)  
Part. IVA - C.F. 00862780061  
Iscriz. C.C.I.A.A. AL 130295  
Iscriz. Tribunale Reg. Soc. 7721  
N. Export AL 009063  
C.C. IT 00862780061  
Cap. Soc. € 1.000.000,00 int. vers.

## **FITTING INSTRUCTIONS**

### **For Termignoni exhaust systems**

#### **A. Dismantling the original exhaust system**

1. Remove any casing impeding clear access
2. Detach the silencer support(s) and the original silencer from the branch pipe and/or exhaust manifold

#### **B. Fitting Termignoni silencer(s)**

1. Fit the Termignoni silencer(s) to the original branch pipe, or use the Termignoni branch pipe to fit the exhaust manifold
2. Attach the silencer(s) with the mounting(s) supplied with the vehicle, leaving the screws and bolts loose
3. Adjust the exhaust system so that when fully inserted it is at least 5 mm from any other component of the vehicle
4. Tighten all screws and bolts
5. Test the vehicle and check all connections, tightening the screws and bolts if necessary
6. After about 100 km check all the connections again and tighten the screws and bolts if necessary

#### **WARNING:**

Take care when working on the exhaust system after testing the vehicle since the surfaces could be very hot

